

**CONTRACT IN BRIEF**

**Location:**  
Dalrymple Place  
Irvine  
KA12 0PG

**Client:**  
North Ayrshire Council  
Physical Environment

**Estimated Project Cost:**  
c. £5,500,000.00

**Proposed Form of Contract:**  
SBCC with Quantities 2005

**Project Management:**  
Property Management & Investment

**Project Development:**  
Housing Services

**Architect:**  
Property Management & Investment

**Structural Engineer:**  
TBC

**M&E Engineer:**  
TBC

**Quantity Surveyor:**  
Property Management & Investment

**Description of Works:**

New Sheltered Housing Unit comprising:  
16 x 1 bedroom houses  
8 x 2 bedroom houses  
9 x 2 bedroom wheelchair liveable houses  
Common areas including lounge, visiting services room & courtyard

**PROGRAMME**

**Site Start:**  
Spring 2019

**Completion:**  
Summer 2020

**Contract Duration:**  
55 weeks

**SERVICES PROVIDED:**

Architectural Design  
Project Management  
Quantity Surveying  
Procurement  
Cost Management  
Programme Management  
Maintenance  
Asset Management  
Energy management

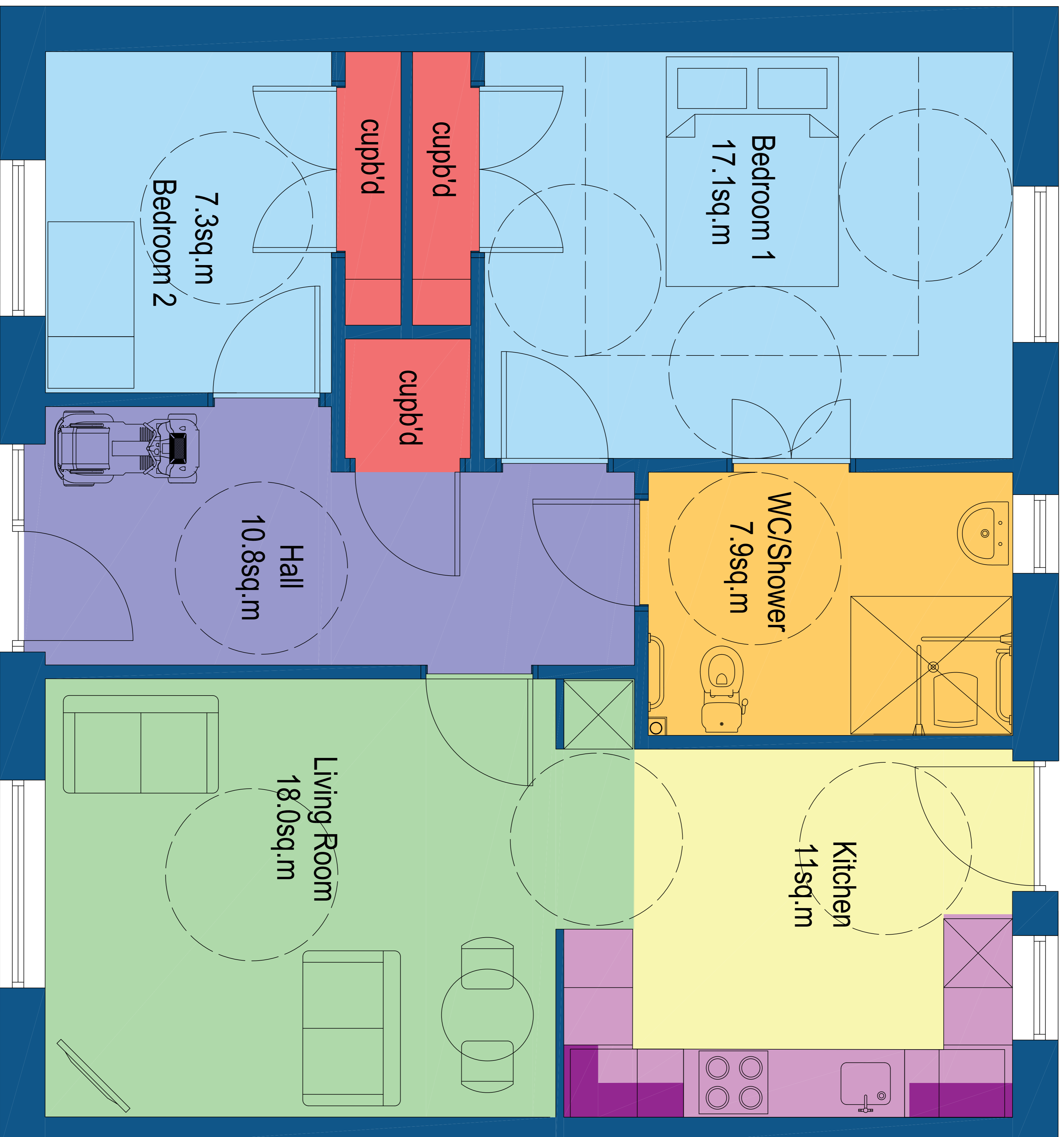

**PROPOSED 2 BEDROOM WHEELCHAIR LIVEABLE HOUSE**