

NEW BUILD SHELTERED HOUSING UNIT, DALRYMPLE PLACE IRVINE

JUNE 2018

CONTRACT IN BRIEF

Location:
Dalrymple Place
Irvine

Client:
KAY12 0FG

Client:
North Ayrshire Council
Physical Environment

Estimated Project Cost:
c. £5,500,000.00

Proposed Form of Contract:
SBCC with Quantiles 2005

Project Management:
Property Management & Investment

Project Development:
Housing Services

Architect:
Property Management & Investment

Structural Engineer:
TBC

M&E Engineer:
TBC

Quantity Surveyor:
Property Management & Investment

Description of Works:
New Sheltered Housing Unit

comprising:
16 x 1 bedroom houses

8 x 2 bedroom houses

9 x 2 bedroom wheelchair liveable houses

Common areas including lounge, visiting services room & courtyard

PROGRAMME

Site Start:
Spring 2019

Completion:
Summer 2020

Contract Duration:
55 weeks

SERVICES PROVIDED:

- Architectural Design
- Project Management
- Quantity Surveying
- Procurement
- Cost Management
- Programme Management
- Maintenance
- Asset Management
- Energy Management

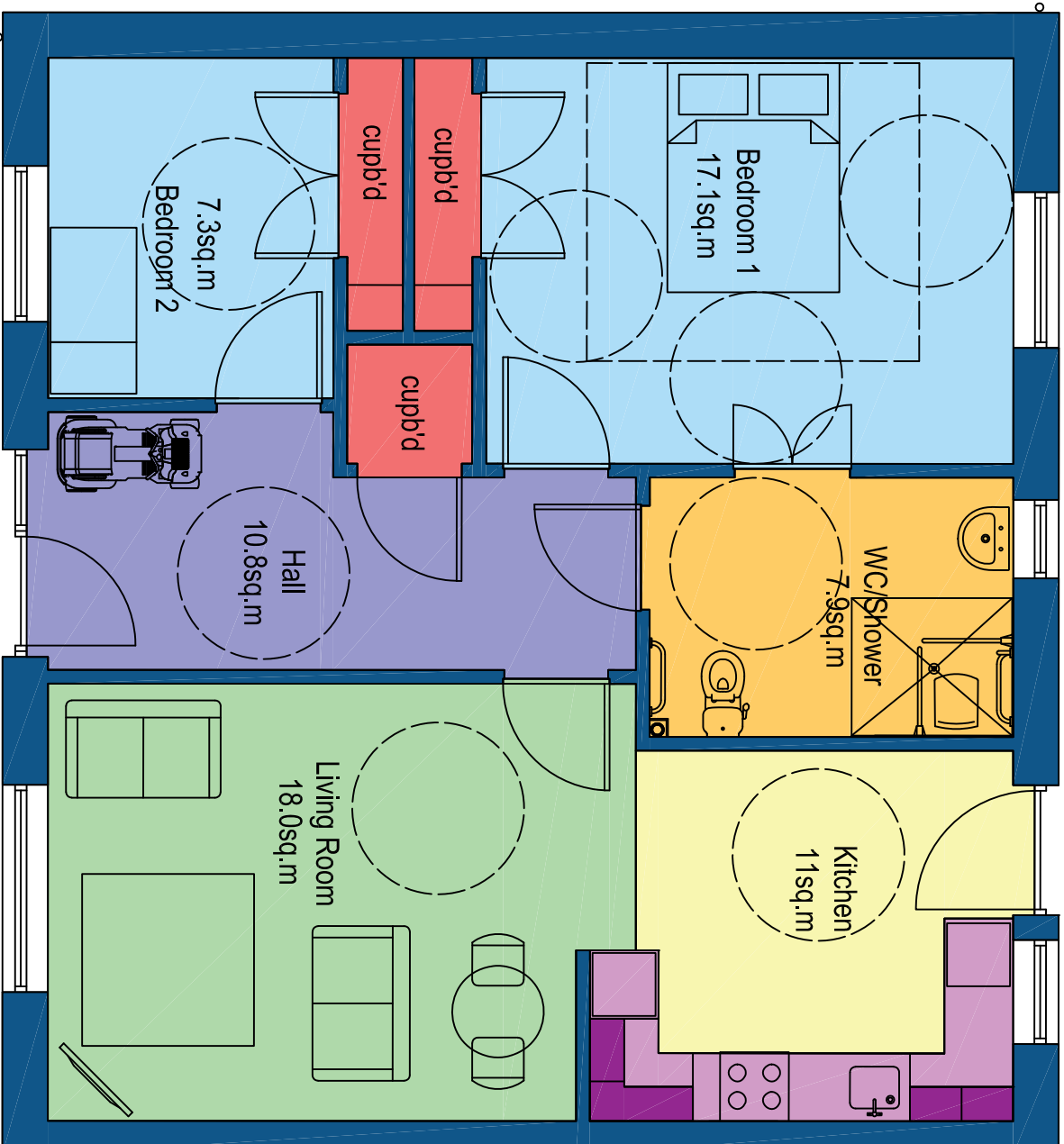

PROPOSED 2 BEDROOM WHEELCHAIR LIVEABLE HOUSE



North Ayrshire Council
Comhairle Spiorachd A'ra Thairi